

Bertram 33 Flybridge Cruiser



SPECIFICATIONS

Length	33'0"	Fuel, Dsl.	255 gals.
Beam	12'6"	Water	70 gals.
Draft	3'0"	Cockpit	72 sq. ft.
Weight	22,800#	Hull Type	Deep-V
Clearance	12'6"	Deadrise Aft	17°
Fuel, Gas	250/315 gals.	Production	1977-92

The Bertram 33 Flybridge Cruiser might best be described as a deep-V fisherman for the cruising family. With her spacious (for a 33-foot boat) interior, the accommodations of the Bertram 33 clearly took precedence over her fishing abilities. Originally offered with a single stateroom, a more popular two-stateroom interior became standard in 1980 and remained essentially unchanged until production ended in 1992. A lower helm was optional, and while the cockpit is small, it's adequate for a couple of light-tackle anglers. In 1981 the flybridge was updated (the helm console was moved aft allowing for bench seating for-



ward), and in 1984 a teak interior decor replaced the original woodgrain mica cabinetry. The Bertram 33 II version, introduced in 1988, had a freshly restyled flybridge and a light oak interior. And finally, changes in 1990 included a revised cabin layout including a separate stall shower in the head. Twin 454-cid gas engines will cruise the Bertram 33 around 19 knots. Optional 260-hp Cats cruise at 22 knots, and newer 320-hp Cats cruise at 25-26 knots (30 knots top). Note that the fuel capacity was increased for the gas models in 1980, although late diesel-powered 33s were still fitted with a 255-gallon tank.

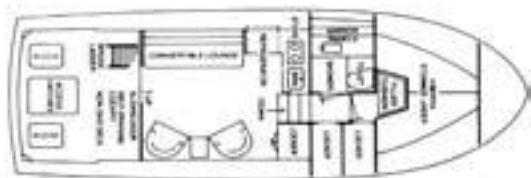

Single Stateroom Layout, 1977-79

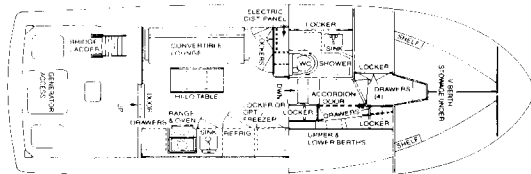

Two Stateroom Layout, 1980-87

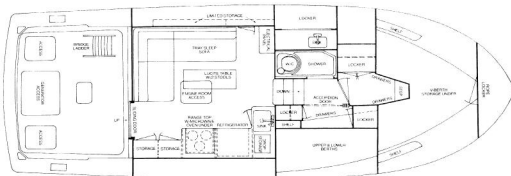

33 MK II Floorplan, 1988-89

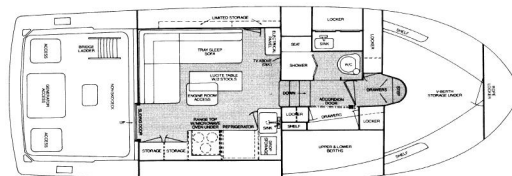

33 MK II Floorplan, 1990-92

[Click Here for Price Data](#)